

STORMWATER PIPE & FITTINGS (SWJ)

STORMWATER PIPE

Manufactured to AS/NZS 1254

PRODUCT CODE	NOMINAL SIZE (MM)	LENGTH (M)	CRATE QTY	MINIMUM PACK QTY
--------------	-------------------	------------	-----------	------------------

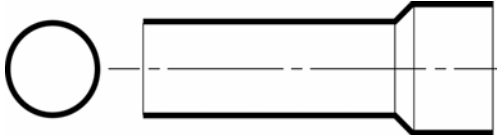

STORMWATER PIPE - SCJ

PRODUCT CODE	NOMINAL SIZE (MM)	DESCRIPTION	LENGTH (M)	CRATE QTY	MINIMUM PACK QTY
20905	75	ROUND DOWNPIPE	3	120	120
20510	90	(EXCLUDING WA)	6	72	72
20501	90	(WA ONLY)	6	72	72
20512	90	SEH-NSW & QLD ONLY	6	72	72
20670	90	SLOTTED	6	72	72
20530	150		6	26	26
20710	150	SLOTTED	6	26	1
20540	225		6	12	1
20550	300		6	6	1
20580	375		6	6	1

STORMWATER FITTINGS (SCJ)

Manufactured to AS/NZS 1254

PRODUCT CODE	NOMINAL SIZE (MM)	DEGREE		CARTON QTY	MINIMUM PACK QTY
--------------	-------------------	--------	--	------------	------------------

STORMWATER ELBOWS

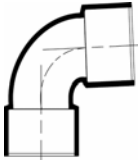

60450	90	15	F & F	80	20
60480	90	22.5	F & F	80	20
60320	90	45	F & F	72	72
60360	90	90	F & F	55	55
60330	150	45	F & F	10	10
60370	150	90	F & F	9	9
60340	225	45	F & F	5	1
60380	225	90	F & F	3	1
* 60299	300	45	F & F	Parallel Socket	1
* 60300	300	90	F & F	Parallel Socket	1

* Denotes Parallel Socket - Vinidex Large Bore Diameter Solvent Cement and Priming Fluid MUST BE USED

STORMWATER ELBOWS M & F

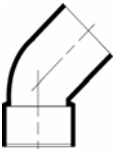

60390	90	15	M & F	80	20
60420	90	22.5	M & F	80	20
60010	90	45	M & F	72	1

STORMWATER JUNCTIONS

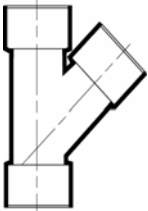

60050	90	45	F & F	30	30
60065	150	45	F & F	4	4
60060	150 x 100	45	F & F	5	5
60565	225	45	F & F	2	1
60548	225 x 100	45	F & F	4	1
60552	225 x 150	45	F & F	3	1
* 60296	225	90	F & F	Parallel Socket	1
* 60301	300	45	F & F	Parallel Socket	1
* 60302	300	90	F & F	Parallel Socket	1

* Denotes Parallel Socket - Vinidex Large Bore Diameter Solvent Cement and Priming Fluid MUST BE USED

STORMWATER ACCESS TEES

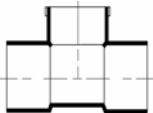

60100	90		F & F	30	30
60110	150		F & F	6	6

STORMWATER COUPLINGS

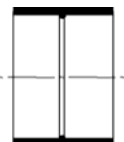

60150	90		F & F	ACCESS	100	20
60160	90		F & F	SLIP	70	70
60190	90x80x65x50x40		F & F	REDUCING	80	10
60153	150		F & F		18	1
60155	225		F & F		12	1

STORMWATER FITTINGS (SCJ)

Manufactured to AS/NZS 1254

PRODUCT CODE	NOMINAL SIZE (MM)	CARTON QTY	MINIMUM PACK QTY
--------------	-------------------	------------	------------------

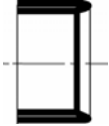

STORMWATER SOCKET REDUCERS

PRODUCT CODE	NOMINAL SIZE (MM)	TYPE	CONNECTOR	CARTON QTY	MINIMUM PACK QTY	
60200	100 x 90		M & F	60	10	
60210	150 x 100		M & F	25	1	
* 60303	225 x 150	LIT	M & F	Parallel Socket	6	1
* 60304	300 x 150	LIT	M & F	Parallel Socket	5	1
* 60305	300 x 225	LIT	M & F	Parallel Socket		1

* Denotes Parallel Socket - Vinidex Large Bore Diameter Solvent Cement and Priming Fluid MUST BE USED

STORMWATER PUSH ON CAPS

PRODUCT CODE	NOMINAL SIZE (MM)	CARTON QTY	MINIMUM PACK QTY
60245	90	160	20
60248	150	45	5
47990	225	21	1



STORMWATER PUSH ON CAP / PLUG

PRODUCT CODE	NOMINAL SIZE (MM)	CARTON QTY	MINIMUM PACK QTY
60240	90	160	20



STORMWATER THREADED ACCESS CAPS

PRODUCT CODE	NOMINAL SIZE (MM)	CARTON QTY	MINIMUM PACK QTY
60250	90	90	10

STORMWATER DOWNPIPE ADAPTORS

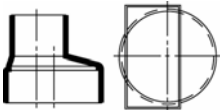

PRODUCT CODE	NOMINAL SIZE (MM)	CONNECTOR	CARTON QTY	MINIMUM PACK QTY
60280	100x50x90	F & F	80	20
60290	100x80x90	F & F	70	10
60830	100x100x100	F & F	35	1